



**Artcoustic<sup>PT</sup>**  
CATALOGUE



## CONTENTS

The World Of Artcoustic	04
The Pursuit Of Beautiful Sound	06
Create Your Sound Space	08
What's Your Style?	10
Complete Design Freedom	12
SL Series	14
CPH Series	50
The Ultimate Cinema Experience	54
Spitfire Series	56
Performance Series	68
Stack Option PS6	76
PDA1000 Amplifier	77
The Collection	78

*“With our Danish design roots and dedication to craftsmanship and engineering, we believe that aesthetics and performance go hand in hand.”*



## THE WORLD OF ARTCOUSTIC

Artcoustic have been designing groundbreaking, world-class loudspeakers since 1998, constantly pushing the limits of convention and challenging the status quo.

Our passion for performance, functionality and design has inspired us to reinvent the conventional loudspeaker with a fresh, modern look. Our roots go back to original Danish loudspeaker design, associated with refined aesthetics and innovative design.

After years of combined design & technical development, we have created a loudspeaker, which looks as good as it sounds, without compromising one to the other.

Our award-winning collection of speakers perform amongst the highest in their class, delivering exceptional efficiency, dynamics and high-quality sound.

We encourage our clients to follow their personal style offering complete design freedom, through our customised design options.

As a result, Artcoustic has become a widely-respected loudspeaker brand for the finest music and cinema systems, worldwide.

*“We use only the highest quality drivers, handpicked from Danish suppliers for the ultimate in sound reproduction.”*

## THE PURSUIT OF BEAUTIFUL SOUND

To create outstanding loudspeakers, you need incredible components, great workmanship and intricate attention to detail. No detail is overlooked in the process to ensure the most efficient and dynamic sound performance possible.

We use only the highest quality drivers, handpicked from Danish suppliers for the ultimate in sound reproduction. To achieve this, high-grade copper coils, and bypass capacitors are employed in all our models, and non-inductive resistors are used throughout.

Each unit is painstakingly constructed by hand - no manufacturing line, no robots. Merely a team of dedicated craftsmen putting the speakers together with care, attention, passion and pride.

Each loudspeaker is visually and technically inspected to ensure all products leaving the factory are deserving of the Artcoustic name.

The result is a loudspeaker that is amongst the finest available.



*Handmade by skilled engineers and craftsmen*



# CREATE YOUR SOUND SPACE

Artcoustic offer a comprehensive and flexible range of loudspeakers to ensure the correct set-up can be specified for the correct application.

We pride ourselves on our bespoke solutions, which enable us to deliver the ultimate sound experience for any interior, small or large, domestic or commercial.

Our design is based around a modular format. All speakers are built to be scalable - from our smallest model to our largest, you can expect the same tonality and quality throughout.

Whether you need a music system for your home, are creating a dedicated home cinema or have a commercial space, Artcoustic can provide a solution that fits your requirements.





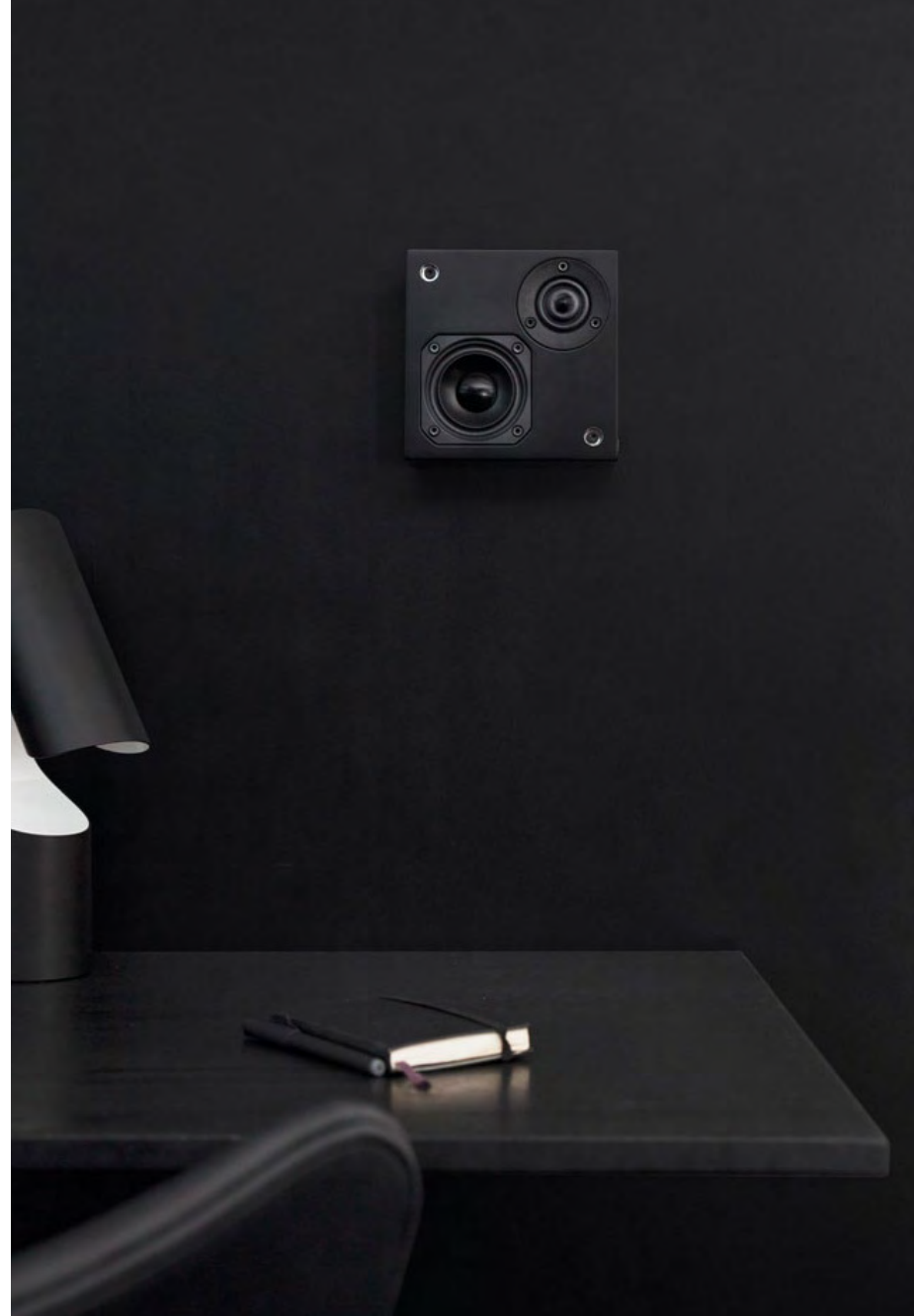
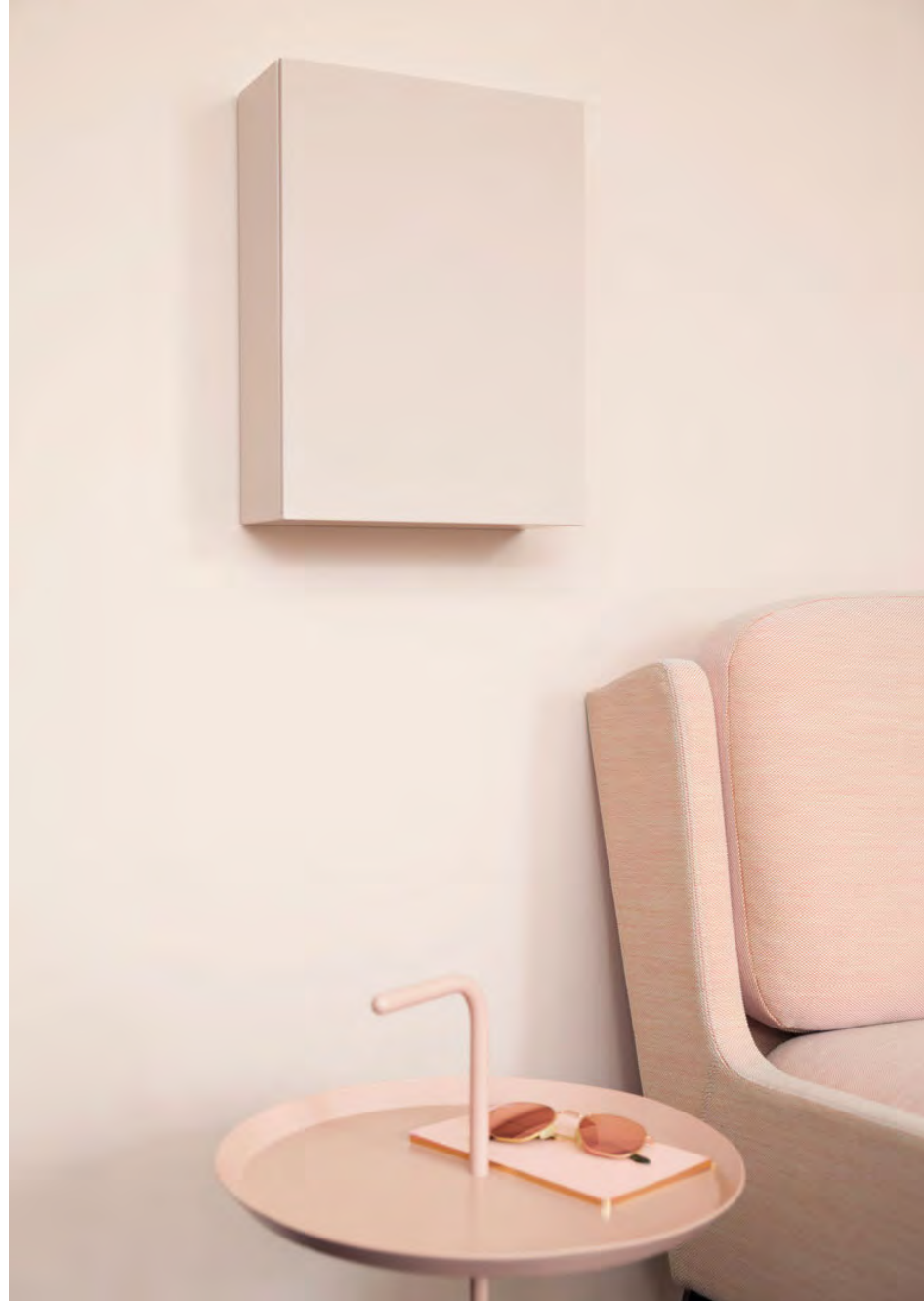

## WHAT'S YOUR STYLE?

Artcoustic provides a canvas like no other, allowing you to create your own unique style. We've taken care of the refined form and quality performance. The look is up to you.

In a few simple steps, you can personalise your loudspeakers to suit your interior. Choose from an unlimited selection of colours for the cabinet, a matching coloured screen or a digitally printed artwork, chosen from our gallery or your own designs.

All our customisable loudspeakers come in standard black or white, and include matching screens, which are interchangeable using a magnetic mount.

# COMPLETE DESIGN FREEDOM



## CHOOSE A CABINET COLOUR & FINISH

Choose from an unlimited selection of colours in a silk, gloss or piano lacquered finish. Standard versions come in black & white.



OR



## CHOOSE A SCREEN COLOUR

Our interchangeable screens can be matched to your speaker to create a subtle finish to compliment your interior.

## CHOOSE PRINTED ARTWORK

If you want to make a statement with your sound, we can print any digital image, either from our gallery or of your own choice.

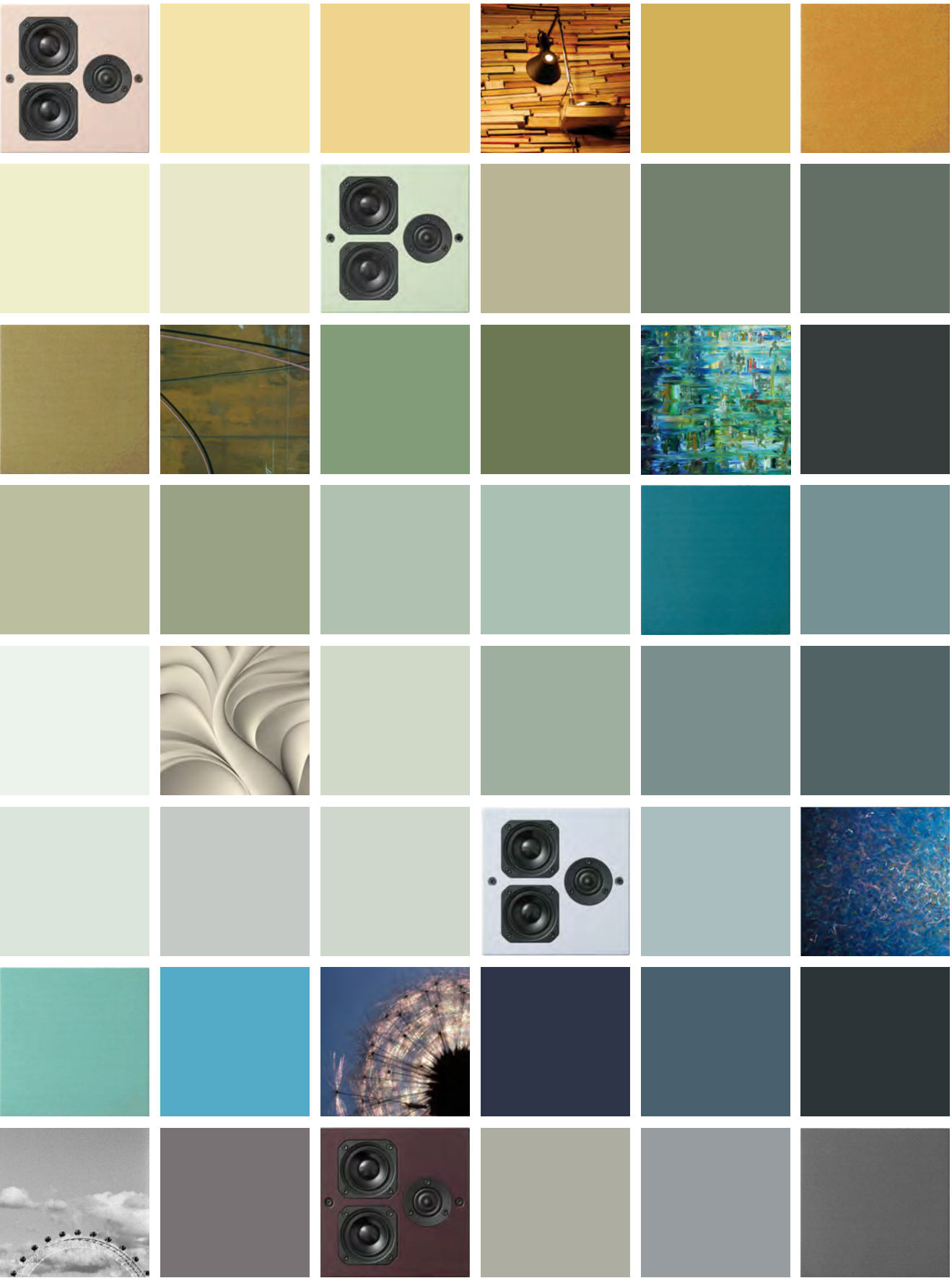



# SL SERIES

Our design team is always looking for new ways to develop our products to ensure we deliver the best possible Artcoustic experience.

The SL Series has been subjected to several years of intensive testing and fine-tuning to deliver a truly unique and groundbreaking loudspeaker range.

The challenge was to create a loudspeaker capable of the dynamics and power of a horn-loaded design, but with the accuracy and quality of a HiFi design.

The solution was to employ an array of world-class drive units to provide incredible efficiency, output and accuracy, whilst also staying true to Artcoustic's signature design ethos.



*“The solution was to employ an array of world-class drive units to provide incredible efficiency, output and accuracy, whilst also staying true to Artcoustic’s signature design ethos.”*



SL TARGET MINI

The smallest speaker in the Artcoustic range, the Target Mini is perfect for smaller lounge systems, as well as rear channels in private cinemas.

An optional ceiling bracket is available for the Target speakers, which makes it possible to achieve optimal sound direction.

SPECIFICATIONS	
Operating Range:	80 Hz (-3 dB) to 40 kHz
Sensitivity:	88 dB
Max SPL:	100 dB
Weight:	1.2 kg
Dimensions:	H 150 • W 150 • D 63 mm

CUSTOMISATION	
Cabinet:	Any colour/finish
Screen:	Any colour
Standard cabinet/screen colours are black/white	

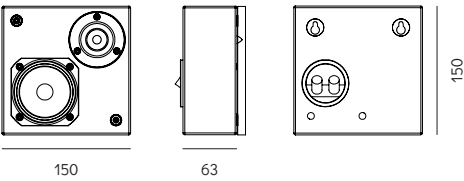

SL TARGET

SL Target is a very flexible loudspeaker, designed for use in smaller rooms for home cinema or Hi-Fi, as well as multiroom applications in kitchens, bedrooms and studies.

An optional ceiling bracket is available for the Target speakers, which makes it possible to achieve optimal sound direction.

SPECIFICATIONS	
Operating Range:	55 Hz (-3 dB) to 40 kHz
Sensitivity:	88 dB
Max SPL:	104 dB
Weight:	2.4 kg
Dimensions:	H 200 • W 200 • D 67 mm

CUSTOMISATION	
Cabinet:	Any colour/finish
Screen:	Any colour
Standard cabinet/screen colours are black/white	

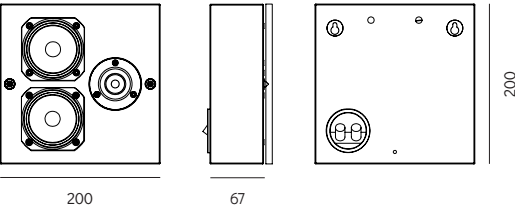









SL SERIES



SL DIABLO

This flexible loudspeaker is designed for use in small to medium size rooms for home cinema or Hi-Fi, as well as multi-room applications such as kitchens, bedrooms and studies. The SL Diablo is a high SPL speaker. For optimal performance it should be partnered with an Artcoustic subwoofer.

**SPECIFICATIONS**  
 Operating Range: 60 Hz (-3 dB) to 40 kHz  
 Sensitivity: 94 dB  
 Max SPL: 109 dB  
 Weight: 4 kg  
 Dimensions: H 360 • W 270 • D 67 mm

**CUSTOMISATION**  
 Cabinet: Any colour/finish  
 Screen: Any colour/printed image  
*Standard cabinet/screen colours are black/white*

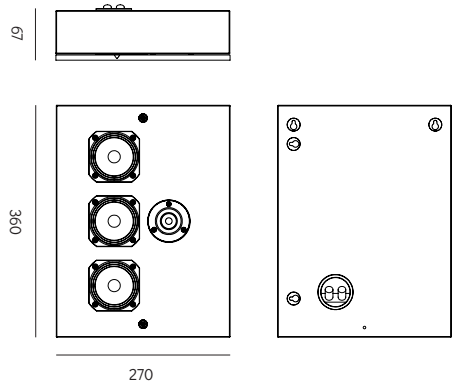





SL 40-30 / 4-2

The 40-30 4-2 is an entry level configuration for our high sound pressure level and modular SL array models. Perfect for serious audio systems and home cinemas in smaller rooms.

**SPECIFICATIONS**  
Operating Range: 60 Hz (-3 dB) to 40 kHz  
Sensitivity: 95 dB  
Max SPL: 112 dB  
Weight: 5.5 kg  
Dimensions: H 400 • W 300 • D 67 mm

**CUSTOMISATION**  
Cabinet: Any colour/finish  
Screen: Any colour/printed image  
*Standard cabinet/screen colours are black/white*

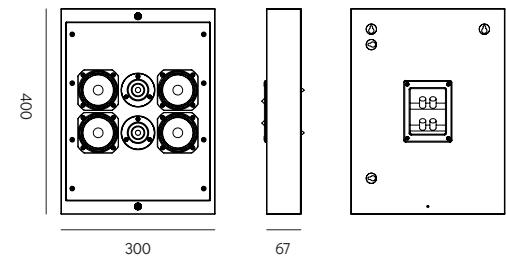

SL 40-30 / 6-3

This entry to mid level configuration of our high sound pressure level and modular SL array models is perfect for serious audio systems and home cinemas. This version delivers higher dynamics and output than the 4-2 version and suits small to medium sized rooms.

**SPECIFICATIONS**  
Operating Range: 65 Hz (-3 dB) to 40 kHz  
Sensitivity: 98 dB  
Max SPL: 115 dB  
Weight: 6 kg  
Dimensions: H 400 • W 300 • D 67 mm

**CUSTOMISATION**  
Cabinet: Any colour/finish  
Screen: Any colour/printed image  
*Standard cabinet/screen colours are black/white*

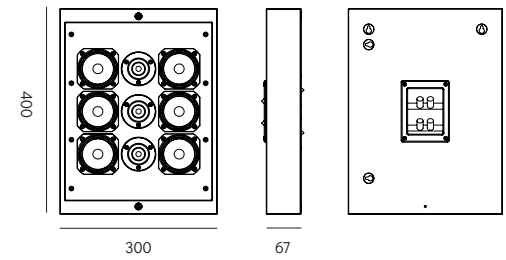



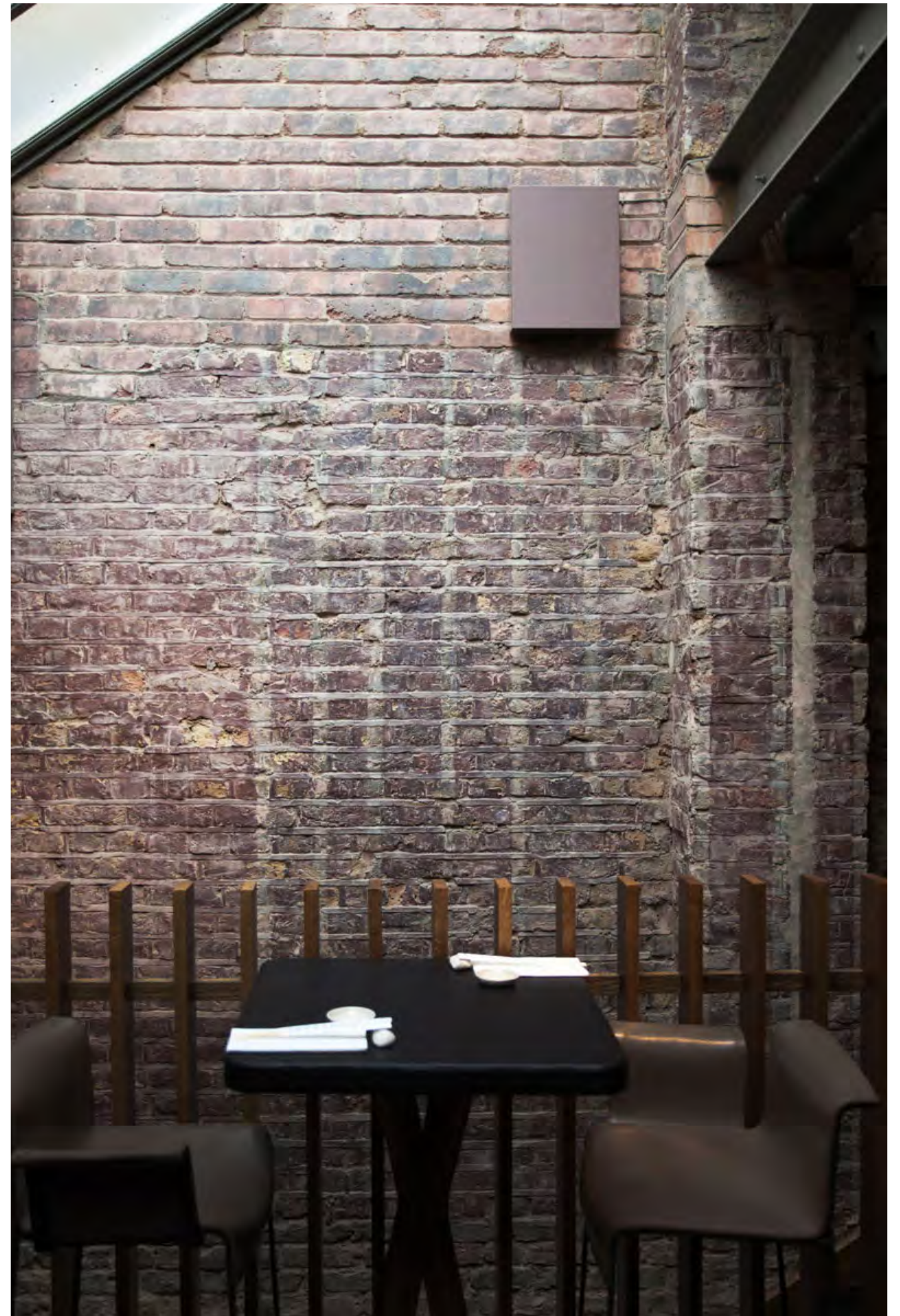





SL 4-2

The entry level configuration of our high sound pressure level and modular SL array. Perfect for serious audio systems and home cinemas.

SPECIFICATIONS	
Operating Range:	60 Hz (-3 dB) to 40 kHz
Sensitivity:	95 dB
Max SPL:	112 dB
Weight:	6.5 kg
Dimensions:	H 500 • W 370 • D 67 mm

CUSTOMISATION	
Cabinet:	Any colour/finish
Screen:	Any colour/printed image
Standard cabinet/screen colours are black/white	

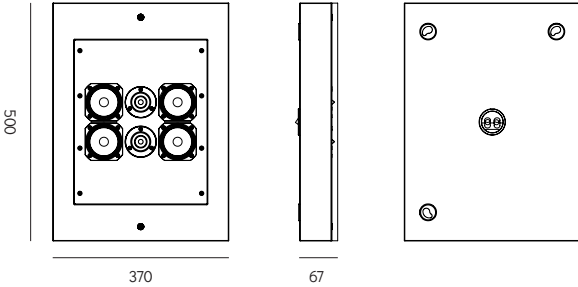

SL 6-3

The entry to mid level configuration of our high sound pressure level and modular SL array. Perfect for serious audio systems and home cinemas, delivering higher dynamics and output than the 4-2 version.

SPECIFICATIONS	
Operating Range:	65 Hz (-3 dB) to 40 kHz
Sensitivity:	98 dB
Max SPL:	115 dB
Weight:	7 kg
Dimensions:	H 500 • W 370 • D 67 mm

CUSTOMISATION	
Cabinet:	Any colour/finish
Screen:	Any colour/printed image
Standard cabinet/screen colours are black/white	

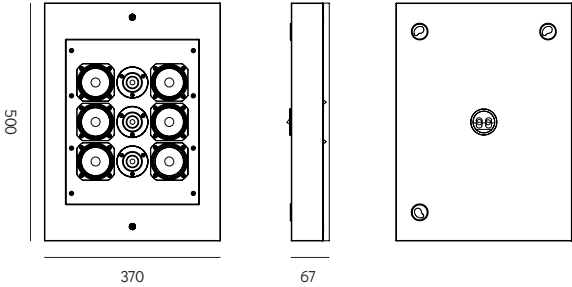

SL 8-4

The mid to high level configuration of our high sound pressure level and modular SL array. Perfect for serious audio systems and home cinemas, delivering higher dynamics and output than the 6-3 version.

SPECIFICATIONS	
Operating Range:	70 Hz (-3 dB) to 40 kHz
Sensitivity:	101 dB
Max SPL:	118 dB
Weight:	8 kg
Dimensions:	H 500 • W 370 • D 67 mm

CUSTOMISATION	
Cabinet:	Any colour/finish
Screen:	Any colour/printed image
Standard cabinet/screen colours are black/white	

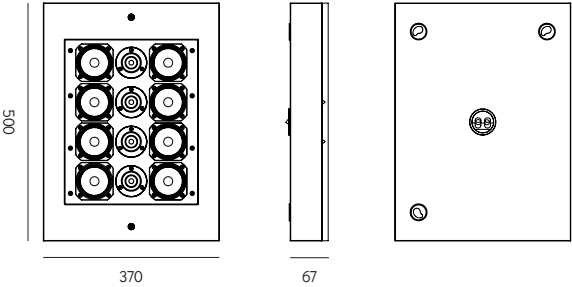





SL 12-6 TAAA

At Artcoustic, our product development team are always looking for innovative and groundbreaking ways to improve our products. We continually invest a huge amount of time and effort to make sure that Artcoustic deliver products at the top of their class, with regards to technical excellence and refined Scandinavian design.

Introducing the latest edition of the SL Series – the Time Aligned Aleksei Array (TAAA). The TAAA is a precise and well-thought-out solution for dealing with high-frequency array phase overlap. By carefully placing high-frequency transducers in a mathematical and geometric formula, the acoustically impossible is now possible.

The design has been optimised in a way that allows the product to achieve a near perfect response curve, without compromising on any of the existing high-end features including: extreme sound pressure levels; sensitivity; extended frequency response; controlled directivity; exceptional speed and transient response. All arranged within a well-designed, slim line cabinet.

- SPECIFICATIONS

Operating Range: 65 Hz (-3 dB) to 40 kHz

Sensitivity: 104 dB

Max SPL: 121 dB

Weight: 15 kg

Dimensions: H 1120 • W 370 • D 67 mm
- CUSTOMISATION

Cabinet: Any colour/finish

Screen: Any colour/printed image

*Standard cabinet/screen colours are black/white*

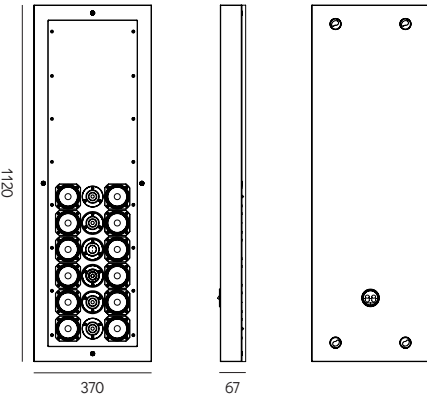

SL 16-8 TAAA

- SL 16-8 is perfect for serious audio systems and home cinemas with higher dynamics and output than the 12-6 versions.
- SPECIFICATIONS

Operating Range: 75 Hz (-3 dB) to 40 kHz

Sensitivity: 101 dB

Max SPL: 124 dB

Weight: 17 kg

Dimensions: H 1120 • W 370 • D 67 mm
- CUSTOMISATION

Cabinet: Any colour/finish

Screen: Any colour/printed image

*Standard cabinet/screen colours are black/white*

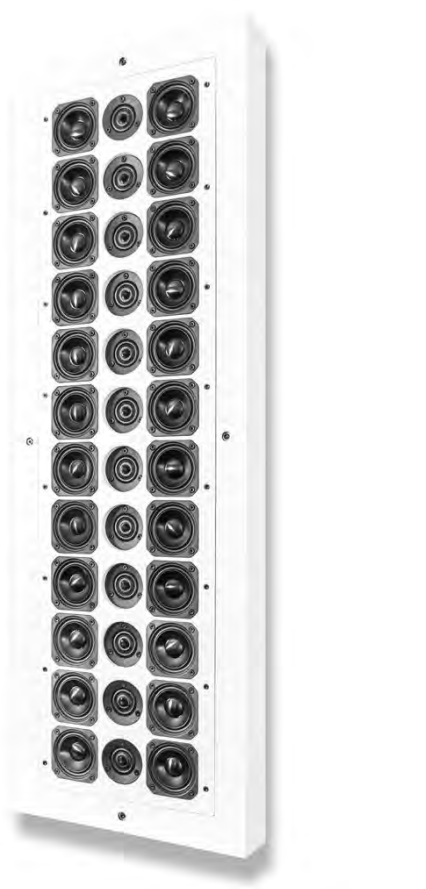
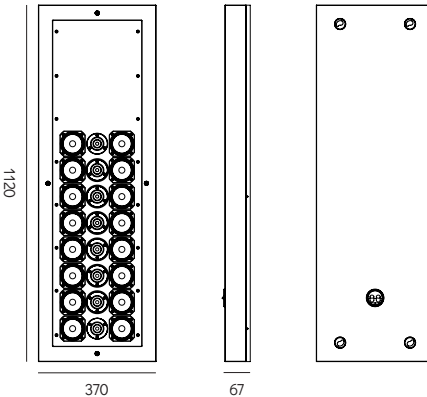

SL 24-12 TAAA

- SL 24-12 is perfect for serious audio systems and home cinemas with higher dynamics and output than the 16-8 versions.
- SPECIFICATIONS

Operating Range: 75 Hz (-3 dB) to 40 kHz

Sensitivity: 110 dB

Max SPL: 130 dB

Weight: 20 kg

Dimensions: H 1120 • W 370 • D 67 mm
- CUSTOMISATION

Cabinet: Any colour/finish

Screen: Any colour/printed image

*Standard cabinet/screen colours are black/white*

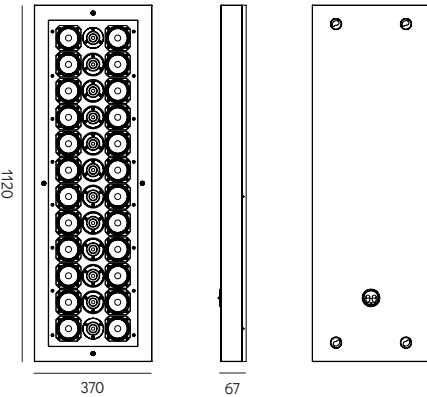









SL SERIES



SL 12-6 FLOOR-STANDING

The SL 12-6 floor-standing speaker is a contemporary and elegant high-end audio solution, for rooms where wall space is not available or purely as a preference. Whether it's a 2-channel Hi-Fi setup or high performance cinema room, the SL 12-6 will deliver an optimal sound output, whilst maintaining the streamline aesthetic appeal, of Artcoustic speakers.

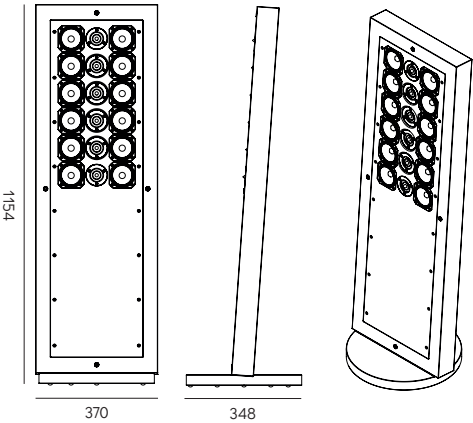

SPECIFICATIONS	
Operating Range:	65 Hz (-3 dB) to 40 kHz
Sensitivity:	104 dB
Max SPL:	121 dB
Weight:	15 kg
Dimensions:	H 1154 • W 370 • D 67 mm

CUSTOMISATION	
Cabinet:	Any colour/finish
Screen:	Any colour/printed image

*Standard cabinet/screen colours are black/white*

Artcoustic pioneered the first concept of an all-in-one LCR (left, centre and right) soundbar as far back as 1997. The SL version is an evolution of this classic loudspeaker and is available in four standard versions, with the option to go bespoke. All feature clean, discrete aesthetics with high output timbre-matched performance.

SL C-1 SOUNDBAR



SL MULTI SOUNDBAR



SL C-1 SOUNDBAR

The C-1 is primarily designed to suit smaller systems, as a discrete centre channel, mounted horizontally beneath a flat screen TV. It is equally suited to be mounted vertically for left and right, as well as rear channels in home cinemas.

SPECIFICATIONS	
Operating Range:	65 Hz (-3 dB) to 40 kHz
Sensitivity:	93/87 dB (mono/stereo)
Max SPL:	105/99 dB (mono/stereo)
Weight:	3.1 kg/BESPOKE
Dimensions:	H 100 • W 650 • D 60 mm/BESPOKE

CUSTOMISATION	
Cabinet:	Any colour/finish
Screen:	Any colour
Standard cabinet/screen colours are black/white	

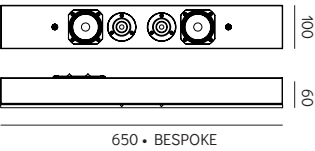

SL MULTI SOUNDBAR

The Multi Soundbar can be used as a single LCR loudspeaker, or for more powerful systems, used as a single mono centre channel. The standard sizes are designed to compliment today's flat screens. Bespoke width options are also available. VESA compatible.

SPECIFICATIONS	
Operating Range:	65 Hz (-3 dB) to 40 KHz
Sensitivity:	97/87 dB (mono/stereo)
LCR Max SPL:	101/109 dB (mono/stereo)
Weight:	5 • 6 • 7 • 8 kg
Dimensions:	H 100 • W S/M/L/XL (see web) • D 61 mm

CUSTOMISATION	
Cabinet:	Any colour/finish
Screen:	Any colour
Standard cabinet/screen colours are black/white	

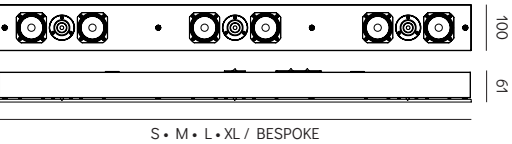

SL C-2/STEREO SOUNDBAR



SL HSPL SOUNDBAR



SL C-2/STEREO SOUNDBAR

The iconic Multi Soundbar is also available in a stereo version. It is designed to be run from a zone of Crestron, Control 4, AMX, Elan G etc. for high quality multi-room performance with the same discrete aesthetics as the Multi Soundbar SL. VESA compatible.

SPECIFICATIONS	
Operating Range:	45 Hz (-3 dB) to 40 KHz
L & R Sensitivity:	89 dB
L & R Max SPL:	104 dB
Weight:	4.5 • 5.5 • 6.5 • 7.5 kg
Dimensions:	H 100 • W S/M/L/XL (see web) • D 61 mm

CUSTOMISATION	
Cabinet:	Any colour/finish
Screen:	Any colour
Standard cabinet/screen colours are black/white	

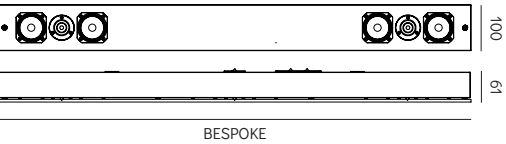

SL HSPL SOUNDBAR

The HSPL Soundbar is a high sound pressure level version of the Multi Soundbar. This version has been specially designed and engineered for applications where very high sound pressure levels are required, matching the larger Artcoustic speaker models such as the SL 12-6, SL 16-8 and SL 24-12. VESA compatible.

SPECIFICATIONS	
Operating Range:	65 Hz (-3 dB) to 40 kHz
Sensitivity:	104/95 dB (mono/stereo)
Max SPL:	120/112 dB (mono/stereo)
Weight:	BESPOKE
Dimensions:	H 100 • W BESPOKE (min.1668) • D 71 mm

CUSTOMISATION	
Cabinet:	Any colour/finish
Screen:	Any colour
Standard cabinet/screen colours are black/white	

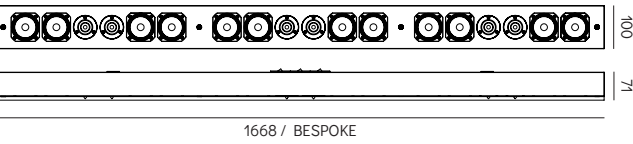







SL SERIES



SL ELEVATE 2-1

This optional floor-standing or wall-hanging multi-purpose monitor shares many characteristics with the other models in the Artcoustic SL range.

SL Elevate is a flexible loudspeaker, designed for use in smaller rooms for home cinema, as well as for multiroom applications. Furthermore, this model has been optimised for Dolby Atmos horizontal listening height, making it the perfect choice for rooms without side or rear walls.

The SL Elevate is designed to work in high-quality two channel music systems and multi-channel home cinemas in conjunction with at least one subwoofer.

SPECIFICATIONS	
Operating Range:	55 Hz (-3 dB) to 40 kHz
Sensitivity:	93 dB
Max SPL:	105 dB
Weight:	6 kg
Dimensions:	H 1285 • W 100 • D 55 mm

CUSTOMISATION	
Cabinet:	Any colour/finish
Screen:	Any colour
Standard cabinet/screen colours are black/white	

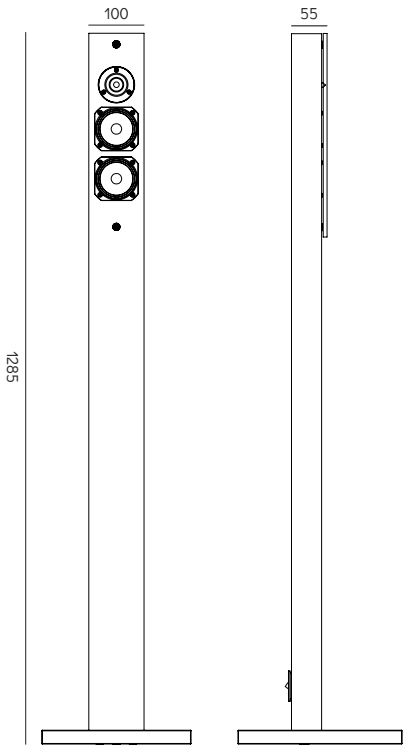



## ARCHITECT SL

The Architect Series has been designed and engineered with the same high specifications as all the other Artcoustic models, leaving no space for compromise on sound quality and build.

Architect SL has been created to deliver Artcoustic performance from an ultra-thin design, with a clean contemporary aesthetic, but allowing the flexibility to install in ceiling or in wall.

Timbre-matched to all the other Artcoustic loudspeakers, Architect SL is the perfect solution for multi-room applications, as well as Dolby Atmos systems.

## SL SERIES



### SL ARCHITECT 2-1

SL Architect 2-1 is the perfect solution for multiroom applications as well as SL and Spitfire cinema systems or lounge Dolby Atmos systems.

SPECIFICATIONS	
Operating Range:	55 Hz (-3 dB) to 40 kHz
Sensitivity:	93 dB
Max SPL:	105 dB
Weight:	2 kg
Dimensions:	H 240 • W 240 • D 74 mm

CUSTOMISATION	
Cabinet:	Any colour/finish
Screen:	Any colour
<i>Standard cabinet/screen colours are black/white</i>	

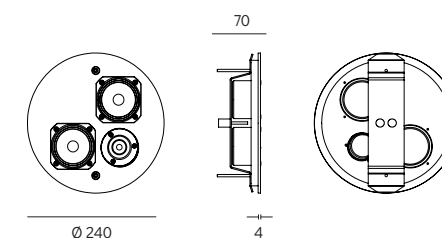

### SL ARCHITECT 4-2

The SL Architect 4-2 is more powerful than the 2-1 for more demanding applications, or used as a single point source stereo speaker where appropriate.

SPECIFICATIONS	
Operating Range:	55 Hz (-3 dB) to 40 kHz
Sensitivity (stereo/mono):	93 dB / 99 dB
Max SPL (stereo/mono):	105 dB / 111 dB
Weight:	3.5 kg
Dimensions:	H 300 • W 300 • D 74 mm

CUSTOMISATION	
Cabinet:	Any colour/finish
Screen:	Any colour
<i>Standard cabinet/screen colours are black/white</i>	

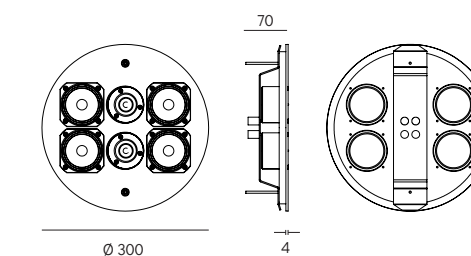





## SL SERIES



### SL ARCHITECT 3-2-1

The SL Architect 3-2-1 is a high SPL full range single source speaker, targeting multiroom applications, including residential and commercials interiors.

SPECIFICATIONS	
Operating Range:	45 Hz (-3dB) to 40 kHz
Sensitivity:	93 dB
Max SPL:	110 dB
Weight:	4,5 kg
Dimensions:	H 300 • W 300 • D 74 mm

CUSTOMISATION	
Cabinet:	Any colour/finish
Screen:	Any colour
<i>Standard cabinet/screen colours are black/white</i>	

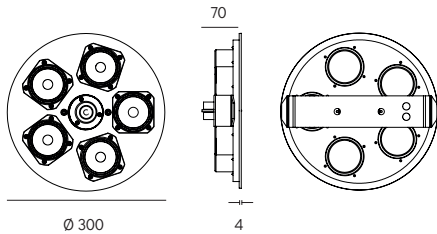

### SL ARCHITECT 2-1 PAS

The SL Architect 2-1 PAS is a high SPL, directional, single-source speaker and is perfect for Dolby Atmos speaker applications, and in-ceiling LCR configurations.

SPECIFICATIONS	
Operating Range:	70 Hz (-3dB) to 18 kHz
Sensitivity:	95 dB
Max SPL:	112 dB
Weight:	3 kg
Dimensions:	H 300 • W 300 • D 153 mm

CUSTOMISATION	
Cabinet:	Any colour/finish
Screen:	Any colour
<i>Standard cabinet/screen colours are black/white</i>	

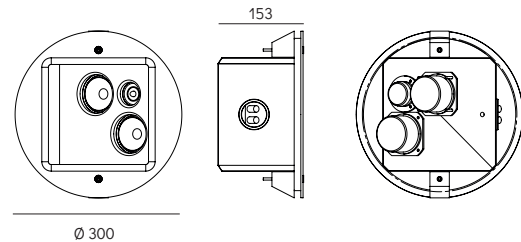

SL SERIES - SUBWOOFERS

Nearly 20 years of technical acoustic evolution has resulted in the most advanced and powerful subwoofer series ever produced by Artcoustic.

By mixing our early Q and Pressure Control technology with the later x 2 bass system, we have ended up with something truly unique: the CPO (Controlled Phase Overlap) design technology.

This new technology and design addresses the issue of depth and power versus cabinet size, with an impressive F3 and F6 point, due to multiple coupled 10" bass units, phase optimisation and controlled frequency overlap.

The new CPO technology allows this performance to be possible in a cabinet much smaller than would otherwise be required. This, alongside higher sensitivity, better heat dispersion and improved F3 and F6 points, makes it possible to operate all the way down to 15Hz.

Wall-hanging

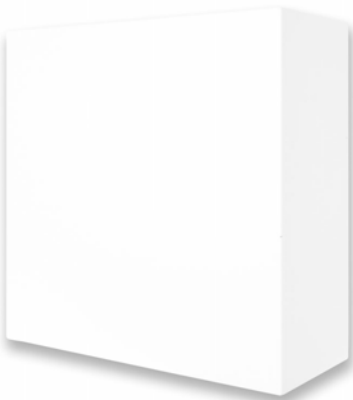

Floor-standing



SL IMPACT 1 SUBWOOFER

Employing one 10" long-throw woofer, the Impact 1 Subwoofer is capable of reproducing low frequency signals accurately and effortlessly, with high power handling and extremely low distortion, right down to 25Hz. The Impact 1 Subwoofer can be positioned on the floor or on the wall.

SPECIFICATIONS

Operating Range: 25 Hz (-6 dB) to 250 Hz  
Sensitivity: 95 dB  
Max SPL: 114 dB  
Weight: 13 kg  
Dimensions: H 450 • W 450 • D 186 mm

CUSTOMISATION

Cabinet: Any colour/finish  
Standard cabinet colours are black/white

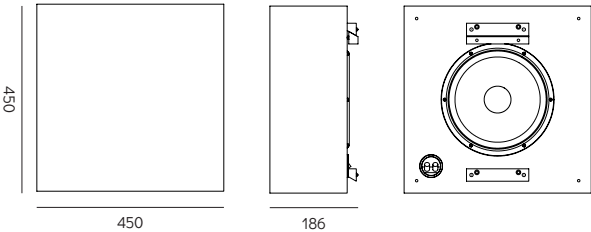

*“Nearly 20 years of technology and acoustic evolution has resulted in the most advanced and powerful subwoofer series ever produced by Artcoustic.”*







SL IMPACT 2 SUBWOOFER

The Impact 2 Subwoofer delivers awesome bass reproduction and, for its size, is one of the most dynamic, powerful and controlled subwoofers on the market. Employing two 10" long-throw woofers combined with our phase optimisation and controlled frequency overlap technology, this subwoofer reproduces low frequency signals accurately and effortlessly, with high power handling and extremely low distortion, right down to 15 Hz.

**SPECIFICATIONS**  
Operating Range: 15 Hz (-6 dB) to 250 Hz  
Sensitivity: 102 dB  
Max SPL: 122 dB  
Weight: 24 kg  
Dimensions: H 483 • W 320 • D 600 mm

**CUSTOMISATION**  
Cabinet: Any colour/finish  
Standard cabinet colours are black/white

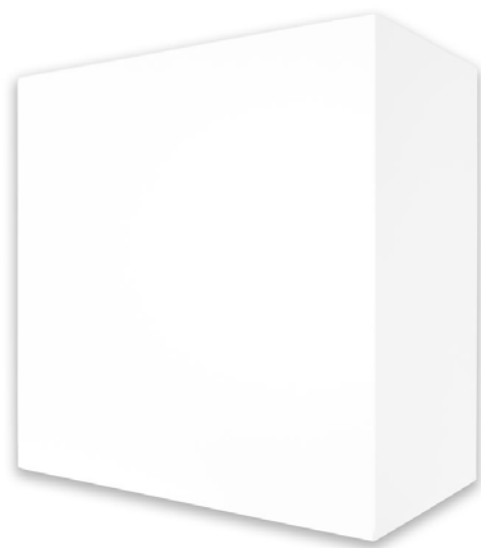
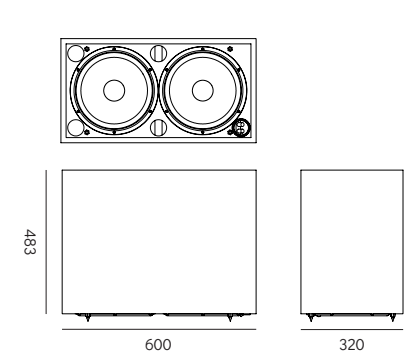

SL IMPACT 3 SUBWOOFER

Employing the same phase optimisation and controlled frequency overlap technology, the Impact 3 Subwoofer features three 10" long-throw woofers. This subwoofer reproduces low frequency signals accurately and effortlessly, with high power handling and extremely low distortion, right down to 15 Hz. Ideal for use in high-end installations where sound quality is paramount.

**SPECIFICATIONS**  
Operating Range: 15 Hz (-6 dB) to 250 Hz  
Sensitivity: 105 dB  
Max SPL: 126 dB  
Weight: 32 kg  
Dimensions: H 633 • W 320 • D 600 mm

**CUSTOMISATION**  
Cabinet: Any colour/finish  
Standard cabinet colours are black/white

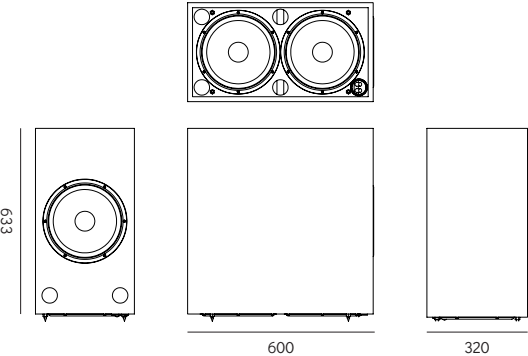

SL IWS-10

The In-Wall Subwoofer (IWS-10) delivers amazing bass, ideal for 2.1 channel multi-room and smaller home cinemas. Employing one 10" woofer, it is capable of reproducing low frequency signals accurately and effortlessly, right down to 35 Hz.

For larger rooms, or where a higher SPL is required, use multiple units.

**SPECIFICATIONS**  
Operating Range: 35 Hz (-6 dB) to 250 Hz  
Sensitivity: 92 dB  
Max SPL: 108 dB  
Weight: 6 kg  
Dimensions: H 370 • W 370 • D 113 mm (w/o baffle)  
H 440 • W 440 • D 131 mm (w. baffle)

**CUSTOMISATION**  
Cabinet: Any colour/finish  
Standard cabinet/baffle colours are black/white

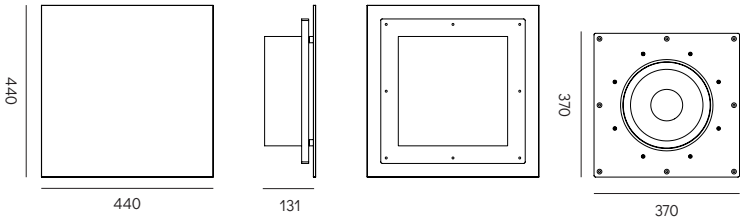

# CPH SERIES

The CPH Series is a range of well-thought-out, all-rounder products. Whether you are looking for high-end sound from a single speaker, two speakers in a stereo music set-up, or multiple speakers for cinemas and multiroom audio, the CPH Series will fulfil all your audio needs.

The series has been designed to ensure the utmost functionality for ease of installation, either when wall-mounted or free-standing.



## CPH SERIES



### CPH-10 PASSIVE

The CPH-10 P is one of Artcoustic's most versatile models. Its slimline profile, combined with a powerful and articulated performance, makes it the ideal choice for high-end Hi-Fi and multiroom audio installations, without the need for a subwoofer.

The CPH-10 P is a single 10 inch, long-throw mid-woofer design, enabling a bass response that extends well down to 40Hz. Indeed, the low frequency performance is the equivalent of speakers twice its size.

#### SPECIFICATIONS

Operating Range: 40 Hz (-3 dB) to 40 kHz  
Sensitivity: 93 dB  
Max SPL: 112 dB  
Weight: 8 kg  
Dimensions: H 400 • W 300 • D 126.5 mm

#### CUSTOMISATION

Cabinet: Any colour/finish  
Screen: Any colour/printed image

*Standard cabinet/screen colours are black/white*

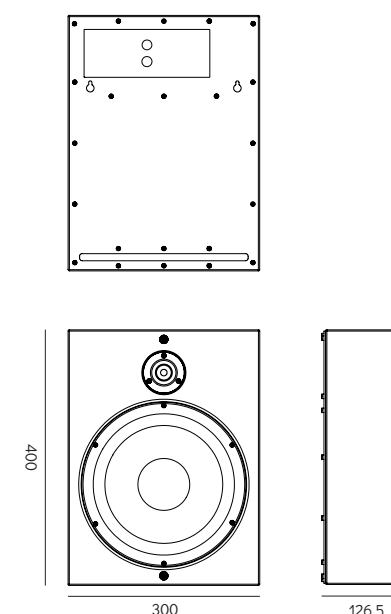





# CPH SERIES



## CPH-TRIO AMPLIFIER

The compact CPH-Trio amplifier comes with an impressive selection of features. This 2.1 digital amplifier features speaker line level input to connect with virtually any device.

SPECIFICATIONS	
Stereo:	2 x 50 watt 4 ohm
Sub:	1 x 100 watt 4 ohm
Full range:	20 Hz - 20 kHz $\pm$ 1 dB
Sub Low-pass filter:	80 Hz 12 dB/oct
Hi-pass filter:	80 Hz 12dB/oct & 100 Hz 12 dB/oct
Input terminals:	Speaker level binding posts
Connectivity:	Bluetooth
Dimensions:	H 180 • W 127 • D 37 mm
Weight:	0.75 kg

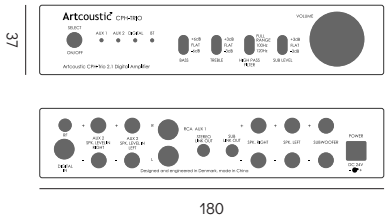

## CPH-10 SUBWOOFER

The CPH-10 subwoofer has an efficient design, producing a fast, dynamic bass response and exceptional musical authority, easily integrated into any small Artcoustic system.

SPECIFICATIONS	
Operating Range:	30 Hz to 250 Hz
Sensitivity:	92 dB
Max SPL:	108 dB
Weight:	9 kg
Dimensions:	H 350 • W 350 • D 186 mm

CUSTOMISATION	
Cabinet:	Any colour/finish
Screen:	Any colour
<i>Standard cabinet/screen colours are black/white</i>	

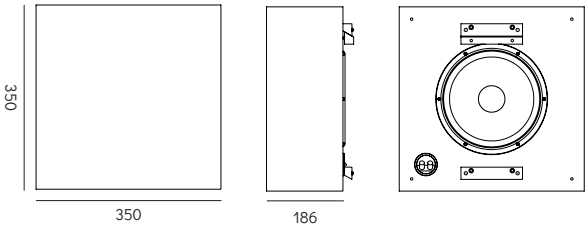





## THE ULTIMATE CINEMA EXPERIENCE

A well designed and specified home theatre can be truly magical. All our cinema systems are designed and installed by trained experts, working to deliver the very best experience possible. Designing a cinema is technically challenging, with every design decision having an impact on other factors. Industry standards give us the ideal parameters to aim for, guaranteeing the very best performance, just as the film director intended.

Seating positions, screen size, image brightness, loudspeaker positions and dynamic range are just some of the key considerations for our design team. Artcoustic's large and highly flexible speaker range ensures we can use the correct loudspeaker for the correct application. A well designed cinema should be able to achieve at least 105 db from each speaker in the listening position.

If the speaker is not capable of this, a huge part of the excitement and dynamic range will be missing. Artcoustic's powerful and highly efficient design allows for cinemas from the smallest snug to the largest auditorium to be designed correctly. Using the correct Artcoustic model ensures the very best performance, resulting in incredible dynamic range, low distortion and stunning accuracy.

*"A well designed and specified home theatre can be truly magical. We guarantee the very best performance, just as the film director intended."*



# SPITFIRE SERIES

The Spitfire Series is designed for the finest dedicated home cinemas, with different configurations to suit almost any room size.

The performance is essentially the same as the Artcoustic SL Series but the models have a more industrial finish, lending themselves perfectly to cinema installations where the speakers are mounted behind the cinema screen.

Artcoustic's Spitfire Series offers world-class cinema sound without taking up valuable space in the room. For a dedicated cinema, Spitfire offers all aspects of performance, dynamics, output, flexibility and practicality.



*“Spitfire delivers world-class cinema sound without taking up valuable space in the room. For a dedicated cinema, Spitfire offers all aspects of performance, dynamics, output, flexibility and practicality.”*



SPITFIRE 4-2

Spitfire 4-2 is the entry level configuration of our high sound pressure level and modular Spitfire array models. Perfect for serious, private and commercial cinemas.

SPECIFICATIONS	
Operating Range:	60 Hz (-3 dB) to 40 kHz
Sensitivity:	95 dB
Max SPL:	112 dB
Weight:	6.5 kg
Dimensions:	H 500 • W 370 • D 67 mm
Cabinet:	Black Spitfire Finish

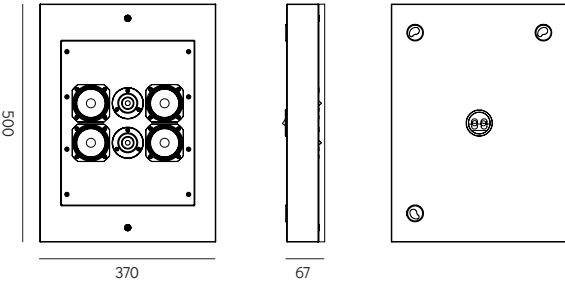

SPITFIRE 6-3

The 6-3 is the entry to mid level configuration of our high sound pressure level and modular Spitfire array. Perfect for serious, private and commercial cinemas, this version delivers higher dynamics and output than the 4-2 version.

SPECIFICATIONS	
Operating Range:	65 Hz (-3 dB) to 40 kHz
Sensitivity:	98 dB
Max SPL:	115 dB
Weight:	7 kg
Dimensions:	H 500 • W 370 • D 67 mm
Cabinet:	Black Spitfire Finish

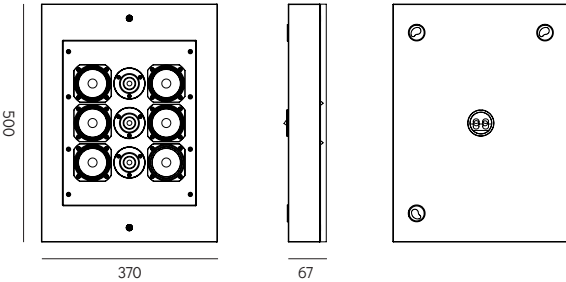

SPITFIRE 8-4

The 8-4 is the mid to high level configuration of our high sound pressure level and modular Spitfire array. Perfect for serious, private and commercial cinemas, this version delivers higher dynamics and output than the 6-3 version.

SPECIFICATIONS	
Operating Range:	70 Hz (-3 dB) to 40 kHz
Sensitivity:	101 dB
Max SPL:	118 dB
Weight:	8 kg
Dimensions:	H 500 • W 370 • D 67 mm
Cabinet:	Black Spitfire Finish

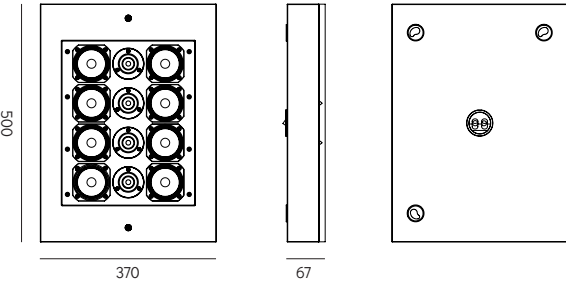





SPITFIRE SERIES



SPITFIRE 12-6 TAAA

The Spitfire TAAA is our newly developed, innovative and groundbreaking speaker design.

The Spitfire TAAA is a precise and well-thought-out solution for dealing with high-frequency array phase overlap. By carefully placing high-frequency transducers within a mathematical and geometric formula, the acoustically impossible is now possible.

The design has been optimised in a way that allows the product to achieve a near perfect response curve, without compromising on any of the existing high-end features, including: extreme sound pressure levels; sensitivity; extended frequency response; controlled directivity; exceptional speed and transient response. All arranged within a well-designed, slim line cabinet.

SPECIFICATIONS	
Operating Range:	65 Hz (-3 dB) to 40 kHz
Sensitivity:	104 dB
Max SPL:	121 dB
Weight:	16 kg
Dimensions:	H 1120 • W 370 • D 67 mm
Cabinet:	Black Spitfire Finish

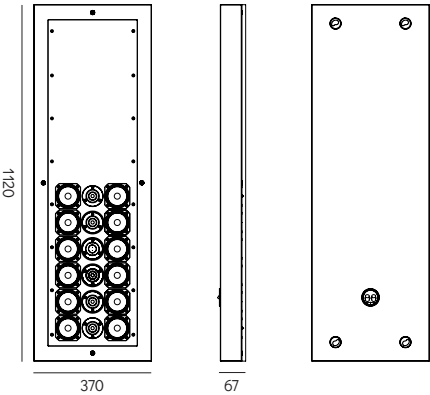

SPITFIRE 16-8 TAAA

Spitfire 16-8 is perfect for high-quality private cinemas. This version delivers higher dynamics and output than the 12-6 version.

SPECIFICATIONS	
Operating Range:	75 Hz (-3 dB) to 40 kHz
Sensitivity:	101 dB
Max SPL:	124 dB
Weight:	18 kg
Dimensions:	H 1120 • W 370 • D 67 mm
Cabinet:	Black Spitfire Finish

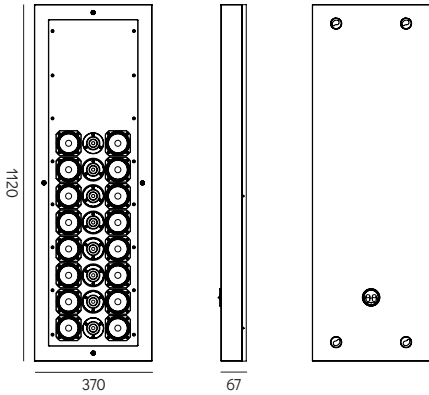

SPITFIRE 24-12 TAAA

Spitfire 24-12 is the reference model for private cinemas. Capable of incredible volume levels and dynamics, with leading, world-class efficiency, this model is designed for state-of-the-art cinemas.

SPECIFICATIONS	
Operating Range:	75 Hz (-3 dB) to 40 kHz
Sensitivity:	110 dB
Max SPL:	130 dB
Weight:	22 kg
Dimensions:	H 1120 • W 370 • D 67 mm
Cabinet:	Black Spitfire Finish

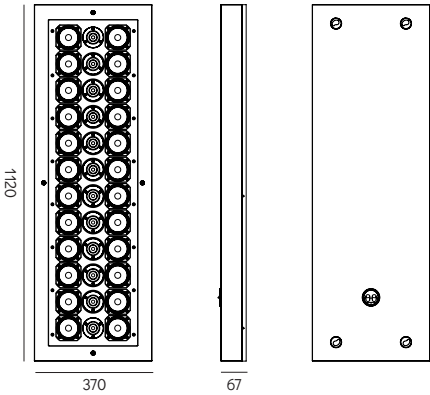







SPITFIRE CONTROL 1

For the ultimate in low-frequency performance, the Spitfire Control Subwoofer delivers awesome bass reproduction. It is one of the most dynamic, powerful and controlled subwoofers on the market, perfect for the very best cinemas.

Compact but very powerful, the Spitfire Control 1 has two precision, handmade 10” long throw bass units, delivering plenty of power, depth and dynamics. Use multiples for medium and large rooms.

For optimal performance, we recommend using the Artcoustic PDA1000, 2-channel digital amplifier.

SPECIFICATIONS	
Operating Range:	20 Hz to 120 Hz
Sensitivity:	95 dB
Max SPL:	118 dB
Weight:	24 kg
Dimensions:	H 844 • W 500 • D 150 mm
Cabinet:	Black Spitfire Finish

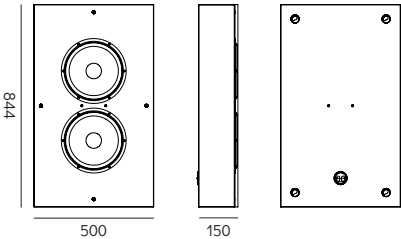

SPITFIRE CONTROL 2

A larger version of the Control 1, with extended dynamic range and higher sound pressure level at frequencies below 30 Hz. The Spitfire Control 2 has two precision, handmade 10” long throw bass units. Use multiples for medium and large rooms.

For optimal performance, we recommend using the Artcoustic PDA1000, 2-channel digital amplifier.

SPECIFICATIONS	
Operating Range:	20 Hz to 120 Hz
Sensitivity:	95 dB
Max SPL:	121 dB
Weight:	29 kg
Dimensions:	H 844 • W 650 • D 200 mm
Cabinet:	Black Spitfire Finish

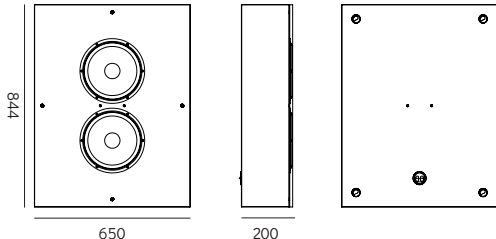

SPITFIRE CONTROL 3

The most powerful subwoofer in the Artcoustic Spitfire line-up, the Control 3 has an even further dynamic range, combined with much higher sound pressure level at frequencies below 30 Hz. The Spitfire Control 3 has three precision, handmade 10” long throw bass units. Use multiples for larger rooms.

For optimal performance, we recommend using the Artcoustic PDA1000, 2-channel digital amplifier.

SPECIFICATIONS	
Operating Range:	15 Hz to 120 Hz
Sensitivity:	95 dB
Max SPL:	124 dB
Weight:	47 kg
Dimensions:	H 844 • W 844 • D 300 mm
Cabinet:	Black Spitfire Finish

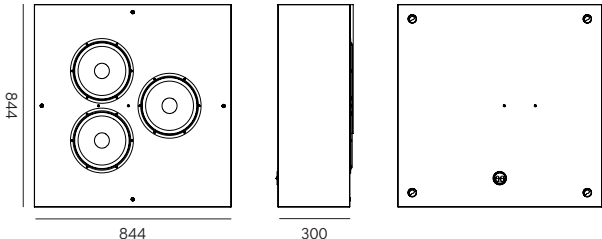



# PERFORMANCE SERIES

When starting out with the Performance Series design concept, it was extremely important for us not to create just another loud PA speaker. Instead, we combined all our knowledge from the existing Spitfire and SL Series technology, to end up with something unique.

We understand the importance of sensitivity and high sound pressure levels, but we have never been willing to sacrifice the true qualities, typically enjoyed with lower sensitivity, Hi-Fi speakers.

The Performance Series is a unique cocktail combining the award-winning Artcoustic array technology, multi-coupled sub units and high pressure levels, all carefully aligned within Danish loudspeaker design principles.

With our unique multiple cone array technology, we achieve a very flat audio response from 15 Hz–20 kHz, with extremely low distortion, guided directivity and all combined with very high sound pressure levels.









PERFORMANCE SERIES



A6

The Performance A6 is a true high SPL all-rounder and can be used as a single sound reinforcement speaker or mounted as multiples with adjustable angles. It is also ideal when wall-mounted or ceiling-mounted as surround and overhead speakers in larger sound pressure level demanding cinema applications.

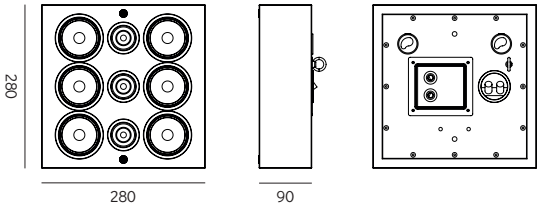

SPECIFICATIONS	
Operating Range:	70 Hz (-6dB) to 20 kHz
Sensitivity:	95 dB
Max SPL:	120 dB
Weight	5.5 kg
Dimensions	H 280 • W 280 • D 99 mm
Cabinet:	Black Performance Finish



PS2

The PS2 is a dual-cone coupled design with a directional horn-load. It has an even further extension in the dynamic range, combined with very high sound pressure level, at frequencies below 25 Hz. The PS2 has two precision, handmade 10” long-throw bass units, delivering impressive power, depth and dynamics.

SPECIFICATIONS	
Operating Range:	25 Hz (-6 dB) to 400 Hz
Sensitivity:	97 dB
Max SPL:	124 dB
Weight:	30 kg
Dimensions:	H 620 • W 386 • D 500 mm
Cabinet:	Black Performance Finish

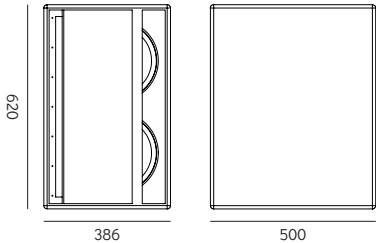

PS4

The PS4 is a multi-drive unit coupled design, with a directional horn load, producing high sound pressure level and very low F6 point (20 Hz) making it suitable for the most demanding applications. The PS4 has four precision, handmade 10” long throw bass units, delivering impressive power, depth and dynamics.

SPECIFICATIONS	
Operating Range:	20 Hz (-6 dB) to 400 Hz
Sensitivity:	103 dB
Max SPL:	130 dB
Weight:	52 kg
Dimensions:	H 620 • W 700 • D 500 mm
Cabinet:	Black Performance Finish

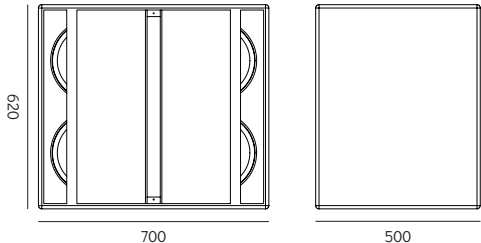

PS6

The PS6 is a multi-drive unit coupled design, with a directional horn load, producing high sound pressure level and very low F6 point (15 Hz) making it suitable for the most demanding applications. The PS6 has six precision, handmade 10” long throw bass units, delivering impressive power, depth and dynamics.

SPECIFICATIONS	
Operating Range:	15 Hz (-6 dB) to 400 Hz
Sensitivity:	108 dB
Max SPL:	136 dB
Weight:	77 kg
Dimensions:	H 900 • W 700 • D 700 mm
Cabinet:	Black Performance Finish

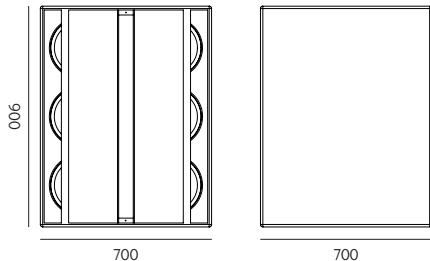



STACK OPTION PS6

The Stack Option PS6 is capable of 136 dB and has been designed and engineered for a diverse range of applications, from large cinema rooms to fixed public address installations and now extending into the demanding club stack market.

SPECIFICATIONS	
Operating Range (Array):	55 Hz (-6 dB) to 20 kHz
Sensitivity:	112 dB
Max SPL:	132 dB
Weight:	28 kg
Dimensions:	H 500 • W 700 • D 100 mm
Cabinet:	Black Performance Structure
Operating Range (Sub):	15 Hz (-6 dB) to 400 Hz
Sensitivity:	108 dB
Max SPL:	136 dB
Weight:	77 kg
Dimensions:	H 900 • W 700 • D 700 mm
Cabinet:	Black Performance Structure

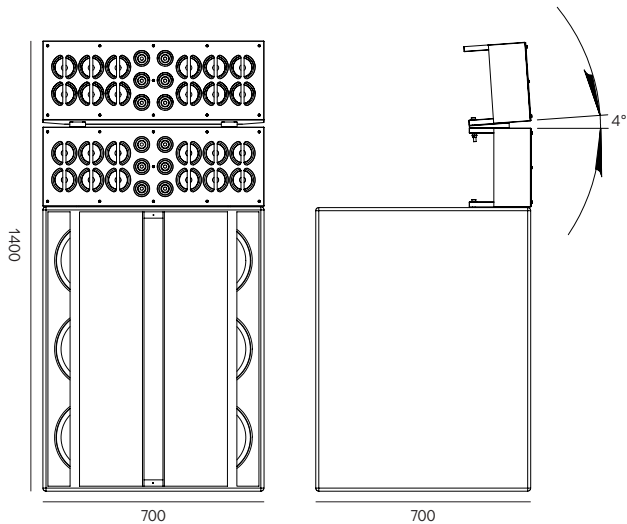

PDA1000 DIGITAL AMPLIFIER

The Artcoustic PDA1000 is an in-house designed, professional 2-channel digital amplifier performing smoothly and accurately, even in the most demanding conditions.

The PDA1000 offers incredible 2-channel, or bridged single-channel performance in a rack mountable chassis, just 1U high. This, together with its high performance and silent running dual fan speed cooling system means it is suitable for almost any application, from recording studios to commercial bars & restaurants, high quality Hi-Fi and home cinema systems. It features two amp modules with a total of 450 watt, 8 ohm per channel, or bridged, single-channel 1000 watt, 8 ohm. It has been optimised to all the Artcoustic subwoofers' impedance and tonality, making it a perfect match with amazing detail, control and dynamics.

SPECIFICATIONS	
Stereo:	2 x 450 Watt 8 ohm
Bridged:	1 x 1000 Watt 8 ohm
Input terminal:	XLR
Dimensions:	H 44 • W 430 • D 180 mm
Weight:	2.8 kg



THE COLLECTION

SL SERIES

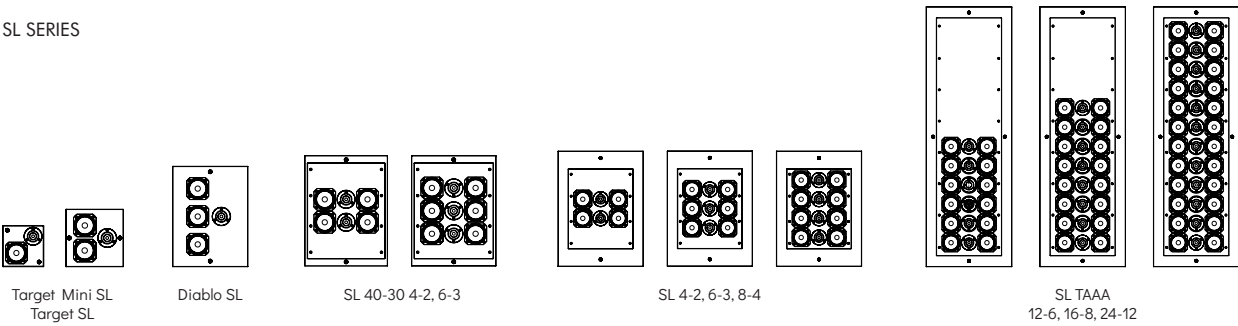

SL SOUNDBARS

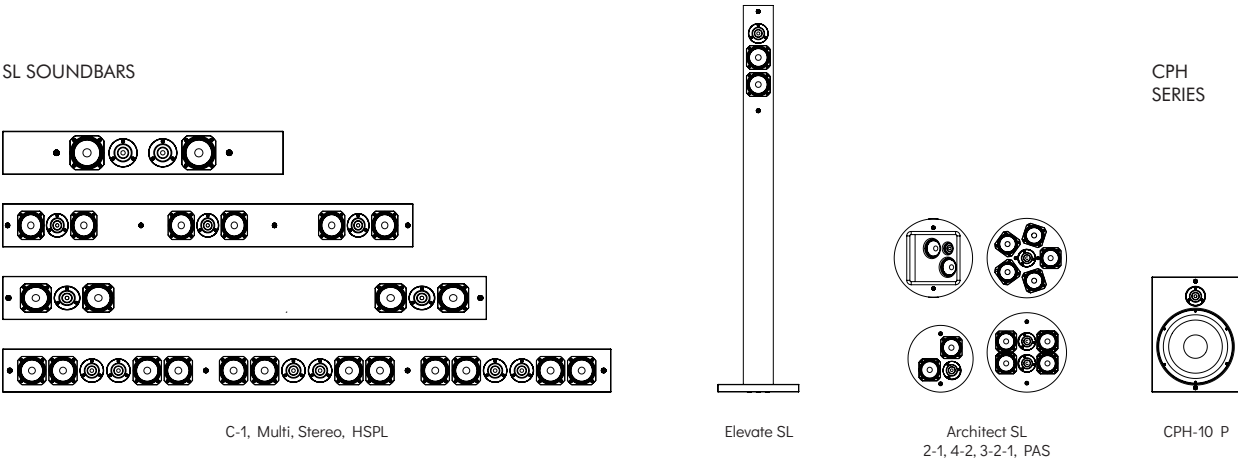

SL SUBWOOFERS

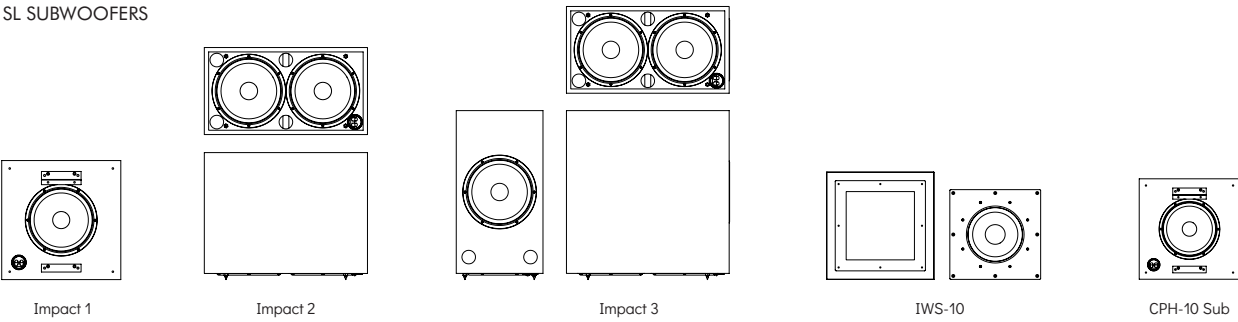

SPITFIRE SERIES

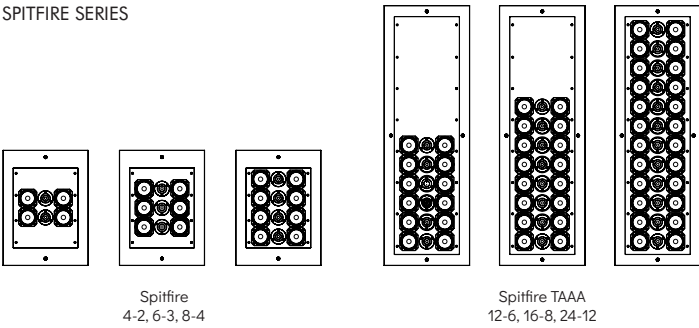

SPITFIRE SUBWOOFERS

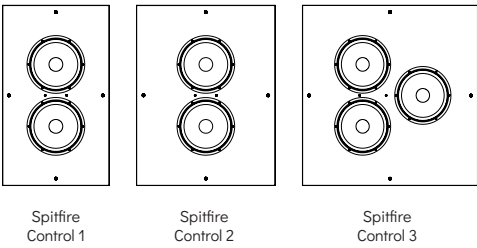

PERFORMANCE SERIES

